



VersiJet™ Series

High Capacity Pumps

Flojet's New VersiJet High Capacity Pumps are backed by over 35 years of operational excellence. This innovative new and improved 5 chamber design provides unequalled performance up to 6 GPM(22.7 LPM).

The Flojet VersiJet Series of High Capacity Pumps are made with either nylon or polypropylene pump heads, with Santoprene®/EPDM or Santoprene®/Viton® diaphragm and valves, offering a wide application availability choice for harsh and abrasive chemicals.

Features and Benefits

- Designed to be the most reliable and versatile pumps on the market today
- The ideal solution for spraying, fluid transfer, filtration, dispensing and pressure boosting
- Several sizing options with flows to 6 GPM (22.7 LPM) and pressure to 70 psi (4.8 bar)
- IPX6 rated pump with sealed motor and pressure switch
- Self-priming to 10' when wetted
- Co-injected molded diaphragm technology



Applications



• General Industrial

- Chemical Washdown
- Evaporative Cooling Systems
- Fluid Transfer



• Agricultural

- Fogging / Misting
- Boom Sprayers (to reach tree tops)



• Automotive

- DEF (Diesel Exhaust Fluid) Transfer
- Fluid Exchange
- Exhaust Cleaning

FLOJET
a xylem brand

Head-Flow Chart

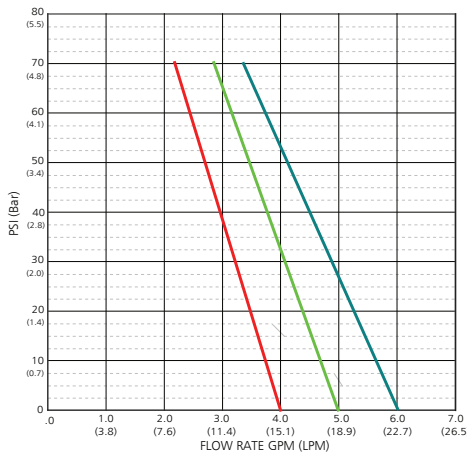

4.0 GPM (15.1 LPM)			5.0 GPM (18.9 LPM)			6.0 GPM (22.7 LPM)		
PSI	GPM	AMPS	PSI	GPM	AMPS	PSI	GPM	AMPS
0	4.0 (15.1)	3.6	0	5.0 (18.9)	5.5	0	6.0 (22.7)	7.4
10 (0.7)	3.8 (14.2)	5.0	10 (0.7)	4.7 (18.1)	7.9	10 (0.7)	5.7 (21.4)	8.3
20 (1.4)	3.5 (13.3)	6.4	20 (1.4)	4.4 (16.8)	9.5	20 (1.4)	5.3 (20.0)	10.1
30 (2.0)	3.3 (12.3)	7.8	30 (2.0)	4.1 (15.5)	10.9	30 (2.0)	4.9 (18.5)	11.6
40 (2.8)	3.0 (11.3)	9.0	40 (2.8)	3.8 (14.2)	12.1	40 (2.8)	4.5 (17.0)	13.0
50 (3.4)	2.7 (10.3)	10.1	50 (3.4)	3.4 (13.0)	13.1	50 (3.4)	4.1 (15.5)	14.4
60 (4.1)	2.5 (9.3)	11.1	60 (4.1)	3.1 (11.9)	14.0	60 (4.1)	3.7 (14.0)	15.2
70 (4.8)	2.2 (8.3)	12.0	70 (4.8)	2.8 (10.6)	14.7	70 (4.8)	3.3 (12.5)	15.6

Note: Pressure, flow and Amp data is tested at 12.8 volts. See Flojet R7300 series for 7.0 GPM models.

Specifications

Motor Design	Perm. Magnet TENV (non-ventilated)
Voltage Options	12 VDC, 24 VDC
Pump Head Material	Glass Filled Nylon and Polypro
Diaphragm Elastomer	Santoprene®
Check Valve Materials	Glass Filled Nylon, EPDM or Viton®
Flow options at open flow	4, 5 or 6 GPM
Maximum Pressure	70 psi (4.8 bar)
Duty Cycle	Intermittent
Weight	7.6lbs (3.5kg)
Certifications	CE, RoHs, IPX6
Standard Port Size Inlet/Outlet	1/2" HB (4 and 5 GPM), 3/4" HB (6 GPM)

Models 4.0 & 5.0 GPM uses "Quad" port fittings; 6.0 GPM uses "Large" port fittings.
Santoprene® is a registered trademark of Monsanto.
Viton® is registered trademark of DuPont Performance Elastomers.

Dimensional Drawing - 5 GPM / 6 GPM models

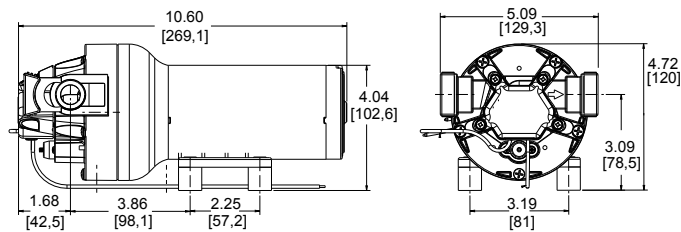

Note: 4 GPM model overall length 9.91in (251.7mm). All other dimensions are the same as the 5 GPM / 6 GPM models. Dimensions in inches [mm]

Model	Volts	Dia / Valve	Switch	Flow at open	Body material
R8400134A	12V	S/V	SW70	4GPM/15.2 LPM	Nylon
R8400144A	12V	S/E	SW70	4GPM/15.2 LPM	Nylon
R8400334A	24V	S/V	SW70	4GPM/15.2 LPM	Nylon
R8400344A	24V	S/E	SW70	4GPM/15.2 LPM	Nylon
R8401344A	24V	S/E	SW70	4GPM/15.2 LPM	Poly Pro
R8410134A	12V	S/V	NSW/NBP	4GPM/15.2 LPM	Nylon
R8410144A	12V	S/E	NSW/NBP	4GPM/15.2 LPM	Nylon
R8410334A	24V	S/V	NSW/NBP	4GPM/15.2 LPM	Nylon
R8410344A	24V	S/E	NSW/NBP	4GPM/15.2 LPM	Nylon
R8420134A	12V	S/V	NSW/BP70	4GPM/15.2 LPM	Nylon
R8420144A	12V	S/E	NSW/BP70	4GPM/15.2 LPM	Nylon
R8420334A	24V	S/V	NSW/BP70	4GPM/15.2 LPM	Nylon
R8420344A	24V	S/E	NSW/BP70	4GPM/15.2 LPM	Nylon
R8500134A	12V	S/V	SW70	5GPM/19 LPM	Nylon
R8500144A	12V	S/E	SW70	5GPM/19 LPM	Nylon
R8500334A	24V	S/V	SW70	5GPM/19 LPM	Nylon
R8500344A	24V	S/E	SW70	5GPM/19 LPM	Nylon
R8501134A	12V	S/V	SW70	5GPM/19 LPM	Poly Pro
R8501334A	24V	S/V	SW70	5GPM/19 LPM	Poly Pro
R8510134A	12V	S/V	NSW	5GPM/19 LPM	Nylon
R8510144A	12V	S/E	NSW	5GPM/19 LPM	Nylon
R8510334A	24V	S/V	NSW	5GPM/19 LPM	Nylon
R8510344A	24V	S/E	NSW	5GPM/19 LPM	Nylon
R8520134A	12V	S/V	BP70	5GPM/19 LPM	Nylon
R8520144A	12V	S/E	BP70	5GPM/19 LPM	Nylon
R8520334A	24V	S/V	BP70	5GPM/19 LPM	Nylon
R8520344A	24V	S/E	BP70	5GPM/19 LPM	Nylon
R8600134A	12V	S/V	SW70	6GPM/22 LPM	Nylon
R8600144A	12V	S/E	SW70	6GPM/22 LPM	Nylon
R8600334A	24V	S/V	SW70	6GPM/22 LPM	Nylon
R8600344A	24V	S/E	SW70	6GPM/22 LPM	Nylon
R8610134A	12V	S/V	NSW/NBP	6GPM/22 LPM	Nylon
R8610144A	12V	S/E	NSW/NBP	6GPM/22 LPM	Nylon
R8610334A	24V	S/V	NSW/NBP	6GPM/22 LPM	Nylon
R8610344A	24V	S/E	NSW/NBP	6GPM/22 LPM	Nylon
R8620134A	12V	S/V	NSW/BP70	6GPM/22 LPM	Nylon
R8620144A	12V	S/E	NSW/BP70	6GPM/22 LPM	Nylon
R8620334A	24V	S/V	NSW/BP70	6GPM/22 LPM	Nylon
R8620344A	24V	S/E	NSW/BP70	6GPM/22 LPM	Nylon

Temperature maximum on the Polypropylene Pump head 130° F (54° C)
Temperature maximum on the Nylon Pump head 160° F (71.1° C)



Warranty: All products of the company are sold and all services of the company are offered subject to the company's warranty and terms and conditions of sale, copies of which will be furnished upon request. The information provided herein is for guidance only, it does not constitute a guarantee of the performance or specification of any individual product or component.

www.xylemflowcontrol.com

USA
Xylem, Inc.
17942 Cowan
Irvine, CA 92614
Tel: (949) 608-3900
Fax: (949) 609-3887

UK
Xylem, Inc.
Bingley Road, Hoddesdon
Hertfordshire EN11 OBU
Tel: +44 (0) 1992 450145
Fax: +44 (0) 1992 467132

GERMANY
Xylem, Inc.
Oststrasse 28
22844 Norderstedt
Tel: +49-40-53 53 73-0
Fax: +49-40-53 53 73-11

CHINA
Xylem, Inc.
30/F, Tower A Hongqiao City
Center of Shanghai 100 Zunyi
Road, Shanghai 200051, China
Tel: +(86) 21 2208 2888
Fax: +(86) 21 2208 2999

ITALY
Xylem, Inc.
Via Tommaseo, 6
20059 Vimercate, Milano
Tel: +39 039 685 2323
Fax: +39 039 666 307